

LOCOSYS GW-31

Quick Start Guide



Alarm status



Blinking: searching for GPS

Steady on: GPS is ready







Battery level

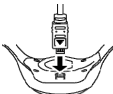

Charging

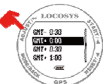
Table 1. Quick setup steps

1	Use the cable that comes along in the package to charge GW-31 for at least 2 hours.	
2	Touch both ADJUST key and START key simultaneously to enter time zone setting screen.	
	Touch UP or DOWN key to select time zone, then touch ADJUST key to finish the setting.	
3	Wear GW-31 to outdoor with clear sky view, then touch GPS key to enable GPS function.	
	GW-31 will automatically set the exact date and time after the satellite icon stops blinking. Then touch GPS key to return to the time display screen.	
4	You have completed the set. Enjoy the life that GW-31 brings to you.	

Note: To change the display language, please go to www.locosystem.com to download software.

Use compass function



To enter compass function, touch **MODE** key four times in the time display screen.



Note: If no compass arrow shows up, please wear GW-31 to draw 8 or turn around in circles to activate compass.

Enable/disable the keylock function



Press **START + MODE** key simultaneously to enable/disable the keylock function

Set points of interest (POI)

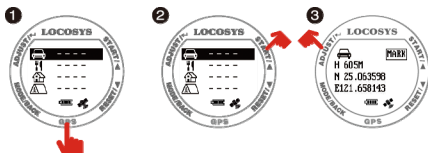

Touch **GPS** key to POI function. After GPS gets ready, you can set the current location to the point of interest.

Touch **UP** or **DOWN** key to select the icon that represents the current location.

After touching **ENTER** key, the display shows the coordinates of the current location. Touch **ENTER** key again to finish.

Note: To use Google™ map input POI, please go to www.locosystem.com to download software.

Go to points of interest (POI)



Touch **UP** or **DOWN** key to select the POI that you want to go, then touch **ENTER** key.

Select the item "GOTO" and touch **ENTER** key to enable guidance function of POI.

GW-31 continuously updates the direction and distance to the POI.

Note: Selection of "MARK" can display the coordinates of the current location. To replace the existed POI by touching **ENTER** key.

Backtrack

This function is like a fairy tale Hansel and Gretel, the brother drops little white pebbles along the way, then follows the glittered pebbles guidance back home.

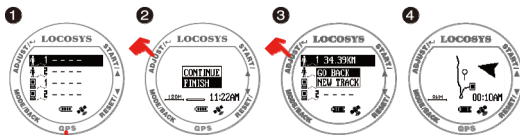

1 Touch **GPS** key to track function. Then touch **UP** or **DOWN** key to select the icon or .

2 Touch **ENTER** key to start recording the track. After arrival at the destination, touch the **ENTER** key to complete the record of this trip.

3 To go back the same way, touch **ENTER** key and select the item 'GO BACK'.

4 GW-31 will guide you back from the nearest track point.

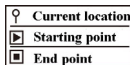

Note: To use Google™ map input track (or) , please go to www.locosystech.com to download software.

Data Logger function

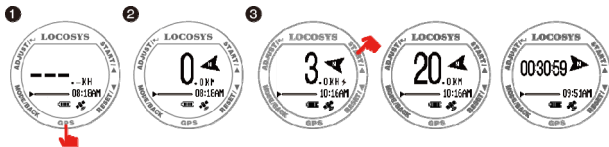

1 Touch **GPS** key to Data Logger function.

2 After GPS gets ready, GW-31 automatically starts recording.

3 Touching **UP** or **DOWN** key can change the display contents, including the current speed, trip distance and trip time.

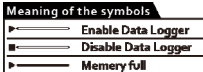

Note: To change the settings of Data Logger, please go to www.locosystech.com to download software.