

CONTROLS

Power/ESC Button

- Press this button and hold to **Power ON**
- Press this button and hold to **Power OFF**
- When power is turned on, this button functions the same as **ESC**
- Press **in** to escape the current page



Thumb Stick (TS) Operation

- The Thumb Stick (TS) is a 5-way directional controller
- Move the TS **Up, Down, Left, or Right** to highlight the option
- Press the TS **In** to confirm, or execute the current option
- Press the **Power/ESC** button to escape the current page

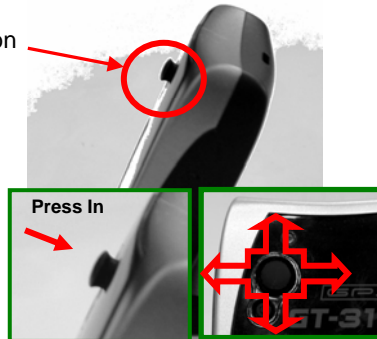

Fast Mark

- At any stage, press **In and Hold** the TS, and the current location will be automatically saved as a waypoint.
- This feature is available **only when** the position has been fixed and [HOLD KEY] is set to [MARK].

Bluetooth*1

- The PIN code is 0000
- The communication baudrate is 38400, 8, n, 1.

Status Indicators

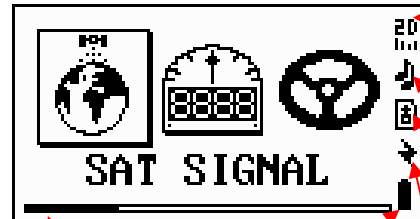

- Scroll Bar
- Battery indicator

- External Power and Other indicators:
 - **External Power Indicator** appears when external power source is connected.
 - **Alert indicator** appears when approaching a waypoint which has been defined for alerting.
 - **Over-speed indicator** appears when the speed exceeds the preset speed.

- **Positioning indicator**
 - 3D Positioning with 3D fixed
 - 2D Positioning with 2D fixed
- **Bluetooth Indicator** Bluetooth enabled (BGT31 only)

- **Buzzer function Indicator** Enabled Disabled

- **Memory Card Indicator**
 - Memory card is correctly inserted
 - Flicking when the system is writing on the memory card
 - Memory card is full and can be removed safely
 - Memory card is correctly inserted but write-protected.
- **Altitude Alert Indicator** appears when altitude reaches the preset altitude.

BEFORE USE

- **Charge the battery:** It takes around 4 hours for the built-in battery to charge fully.
- **Initialize the unit:** Leave the unit outside with a clear view of sky until it has fixed its position. Subsequently, it needs only around 45 seconds to find its location. When the unit has not been used for long time, or if it's being used far from where you got the last fixed position(≥300KM), you will need to cold start the unit before use.
- **Configure the system:** Set up the parameters under the Settings page. The system will store your configuration in its built-in flash memory.
- **Now, you can mark and edit waypoints, and create a route.**

Please go to www.locosystem.com to download latest value-added software/driver and manual.